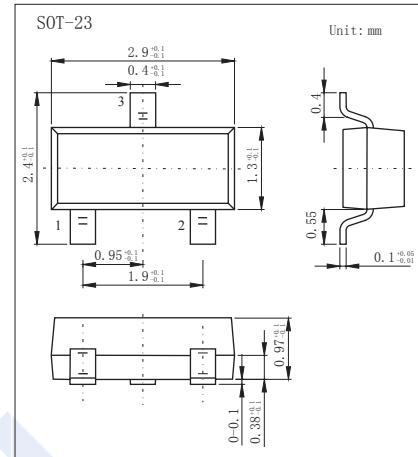
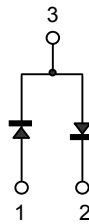

## Switching Diodes

## DAN217 (KAN217)

## ■ Features

- Ultra high speed switching
- High reliability

■ Absolute Maximum Ratings  $T_a = 25^\circ\text{C}$ 

Parameter	Symbol	Rating	Unit
Reverse Voltage	$V_{RM}$	80	V
Reverse Voltage (DC)	$V_R$	80	
Average rectified forward current (Single)	$I_o$	100	mA
Forward Current (Single)	$I_{FM}$	300	
Surge current ( $t=1\mu\text{s}$ )	$I_{\text{surge}}$	4	A
Power Dissipation	$P_d$	200	mW
Junction Temperature	$T_J$	150	$^\circ\text{C}$
Storage Temperature range	$T_{\text{stg}}$	-55 to 150	

■ Electrical Characteristics  $T_a = 25^\circ\text{C}$ 

Parameter	Symbol	Test Conditions	Min	Typ	Max	Unit
Reverse breakdown voltage	$V_R$	$I_R = 100 \mu\text{A}$	80			V
Forward voltage	$V_F$	$I_F = 100 \text{ mA}$			1.2	
Reverse voltage leakage current	$I_R$	$V_R = 70 \text{ V}$			0.1	$\mu\text{A}$
Capacitance between terminals	$C_t$	$V_R = 6 \text{ V}, f = 1 \text{ MHz}$			3.5	pF
Reverse recovery time	$t_{rr}$	$V_R = 6 \text{ V}, I_F = 5 \text{ mA}, R_L = 50 \Omega$			4	ns

## ■ Marking

Marking	BA*
---------	-----

# Switching Diodes

## DAN217 (KAN217)

### Typical Characteristics

